

LOC	DIST	REV	ZONE	LTR	DESCRIPTION	DATE	APPD
G	14	P	A		REVISED PER 0720-0230-93	2/28/94	DAF

**METRIC**  
 DIMENSIONS LISTED IN mm [ INCHES ]

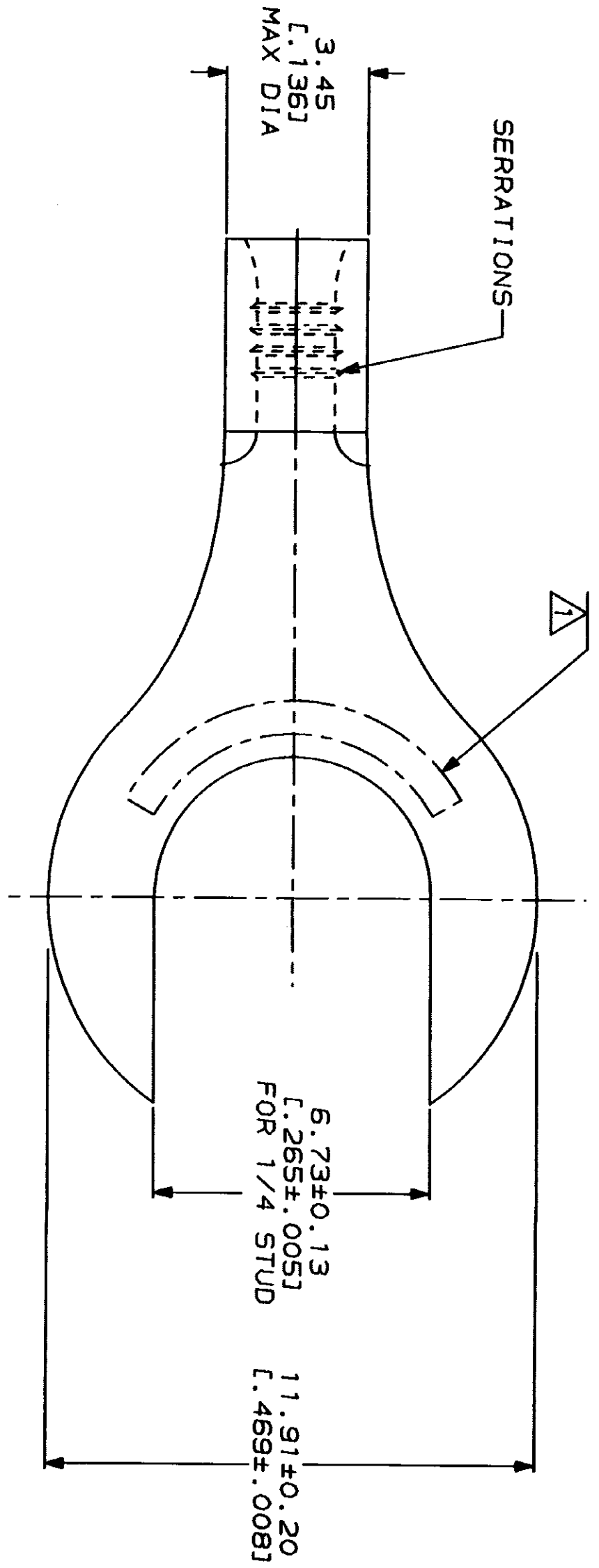

<b>AMP</b> WIRE RANGE 22-16 AWG STRANDED	<b>UL</b> E13288 Listed
<b>LR7189</b> Certified	MILITARY P/N AND CLASS
NOT CERTIFIED	NOT APPLICABLE

△ STAMP AMP 22-18\* APPROX AS SHOWN  
 22-16 TERMINALS ARE STAMPED 22-18 IN  
 ACCORDANCE WITH MILITARY SPECIFICATION  
 MIL-T-7928, COMMERCIAL WIRE RANGE IS 22-16

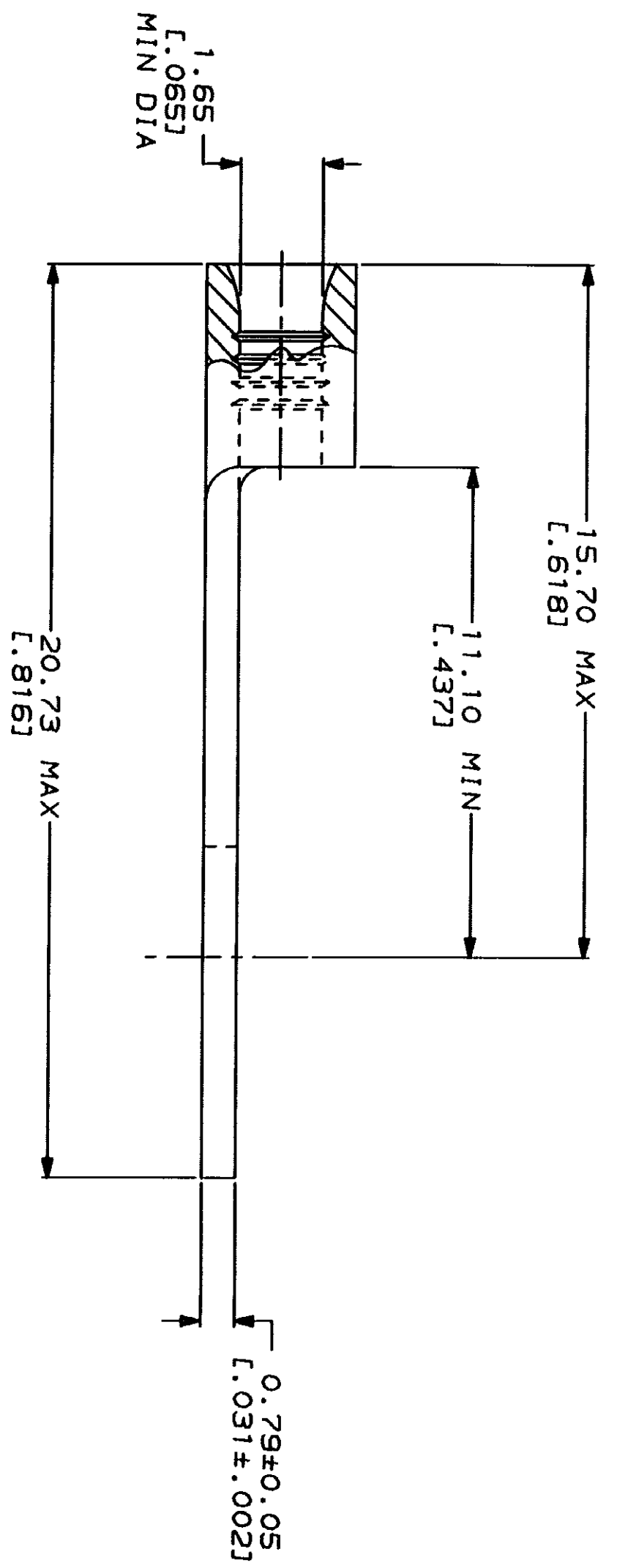

AMP INCORPORATED  
 CUSTOMER SERVICE SYSTEMS

FOR ADDITIONAL PRODUCT INFORMATION OR COPIES OF DRAWINGS AND TECHNICAL DOCUMENTS	PRODUCT INFORMATION CENTER 1-800-522-6752
FOR APPLICATION TOOLING INFORMATION	TOOLING ASSISTANCE CENTER 1-800-722-1111
FOR ORDER ENTRY	1-800-526-5142

MAX RECOMMENDED OPERATING  
 TEMPERATURE: 170°C MAX

VOLTAGE RATING:  
 NOT APPLICABLE

WIRE CROSS SECTIONAL AREA RANGE:  
 0.26-1.65mm<sup>2</sup> [509-3,260] CIR MILS  
 STRANDED

THIS DRAWING IS A CONTROLLED DOCUMENT FOR  
 AMP INCORPORATED. IT IS SUBJECT TO CHANGE  
 WITHOUT NOTICE. FOR THE LATEST REVISION,  
 CONSULT THE CONTROL LISTING FOR THE LATEST REVISION.

DO NOT SCALE PRINT.  
 UNLESS SPECIFIED  
 DIMENSIONS IN mm - FINISHES -  
 TOLERANCES ON:  
 2 P.L.C DEC # -  
 3 P.L.C DEC # -  
 ANGLES

MATERIAL  
 COPPER PER  
 ASTM B-152  
 ANNEALED

FINISH  
 TIN PLATE  
 0.0025±L.000100] MIN  
 THK PER MIL-T-10727

DR 2-23-93  
 TA BRINKMAN  
 CHK 2-23-93  
 DA PATTERSON  
 APPD 2-23-93  
 DE MILLER  
 APPD 2-23-93  
 JL MECKLEY  
 PRODUCT SPEC  
 APPLICATION SPEC  
 WEIGHT -  
 SCALE 8:1

<b>AMP</b> AMP Incorporated Harrisburg, PA 17105-3508	323837 PART NO
TERMINAL, SLOTTED RING TONGUE, BUDGET	323837
SIZE CAGE CODE 00779	DRAWING NO 323837
SCALE 8:1	SHEET 1 OF 1