

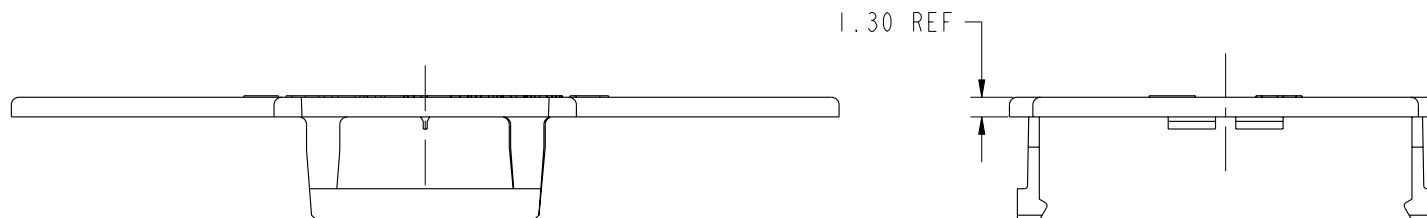

This document is the property of and embodies CONFIDENTIAL and PROPRIETARY information of FCI. No part of the information shown on this document may be used in any way or disclosed to others without the written consent of FCI. Copyright FCI.

SEE TABLE  
SEE NOTE 3

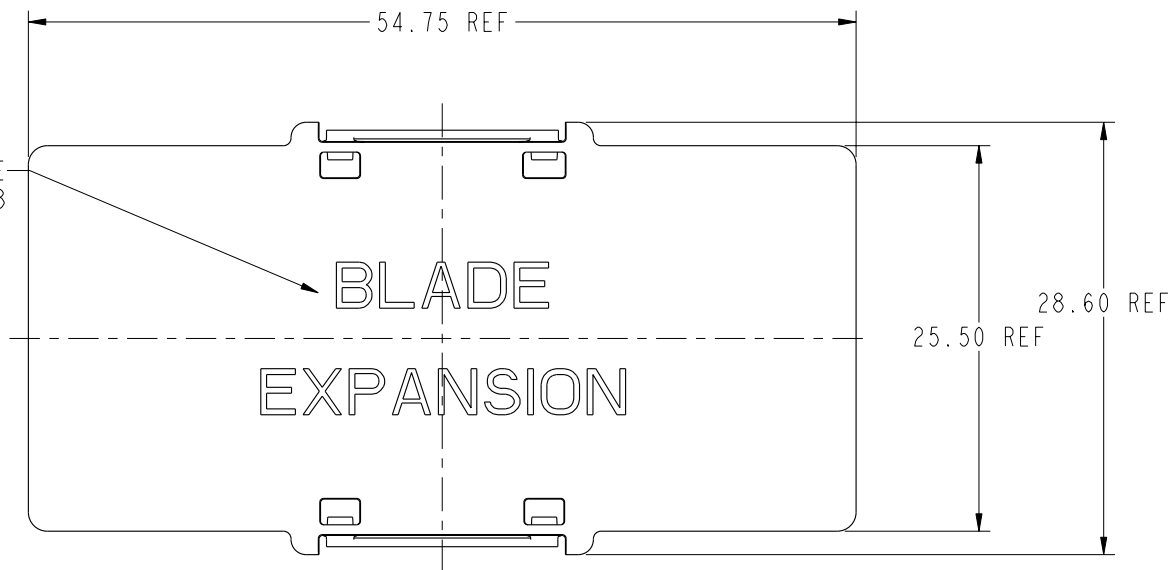

**CONFIDENTIAL**

mat'l code				SEE NOTE 1		tolerances unless otherwise specified		CUSTOMER		www.fciconnect.com	
ltr	ecn no.	dr	date	linear	0.X ±0.3		COPY			title	
A	V04-1041	TAB	10/19/04		0.XX ±0.10		MM			GIG-Array 296 POS. PROTECTIVE CAP	
B	V05-0840	LP	11/14/05		0.XXX ±0.050		2:1			product family GIG-Array code 213	
C	V06-0558	LP	2006/06/21	angles	0° ±2°		scale		size A 10042773 sheet 1 of 2		
				dr	T. BRUNGARD	07/19/04					
				enr	M. STRAWSER	07/19/04					
				chr	M. STRAWSER	07/19/04					
				appd	M. STRAWSER	07/19/04					
sheet index	revision sheet	C 1	C 2							cage code 22526	

PRODUCT NUMBER	OPTIONAL RAISED TEXT (SEE NOTE 3)
10042773-001	NONE
10042773-001LF	NONE
10042773-002	BLADE EXPANSION
10042773-002LF	BLADE EXPANSION
10042773-003	BLADE EXPANSION
10042773-003LF	BLADE EXPANSION
10042773-004	BLADE SCALABILITY CONNECTOR
10042773-004LF	BLADE SCALABILITY CONNECTOR

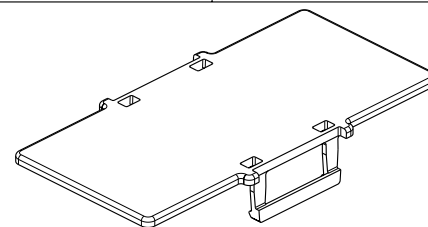

10042773-001  
10042773-001LF  
SCALE 1:1

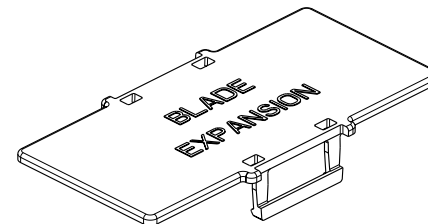

10042773-002  
10042773-002LF  
10042773-003  
10042773-003LF  
SCALE 1:1

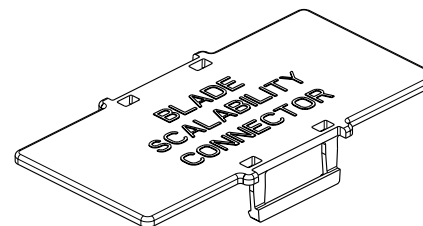

10042773-004  
10042773-004LF  
SCALE 1:1

**NOTES:**

- ① MATERIAL:  
LCP  
COLOR: BLACK  
UL RATING: 94 V-0
2. THIS PROTECTIVE CAP SHOULD NOT BE USED AS A PICK & PLACE CAP DURING REFLOW.
- ③ OPTIONAL RAISED TEXT USE 12pt. HELVETICA FONT, CENTER JUSTIFIED SEE TABLE.
4. THE PRODUCT WHERE THE PART NUMBERS END IN "LF" MEET EUROPEAN UNION DIRECTIVES AND OTHER COUNTRY REGULATIONS AS DESCRIBED IN GS-22-008. ALL PRODUCTS WILL WITHSTAND EXPOSURE TO 260° C FOR 60 SECONDS IN A CONVECTION, INFRA-RED OR VAPOR PHASE REFLOW OVEN.
5. FOR LEAD FREE PART NUMBERS ADD "LF" SUFFIX, EXAMPLE 10042773-00XLF.



This document is the property of and embodies CONFIDENTIAL and PROPRIETARY information of FCI. No part of the information shown on this document may be used in any way or disclosed to others without the written consent of FCI. Copyright FCI.

**CONFIDENTIAL**

mat'l code				SEE NOTE 1		tolerances unless otherwise specified		CUSTOMER		FCI www.fciconnect.com	
ltr	ecn no.	dr	date	linear	0.X ±0.3		COPY		projection	title	
C	-	-	-		0.XX ±0.10		MM			GIG-Array 296 POS. PROTECTIVE CAP	
					0.XXX ±0.050		←→			product family GIG-Array code 213	
				angles	0° ±2°		scale		size		
				dr	T. BRUNGARD	07/19/04	1:1		dwg no		
				enrg	M. STRAWSER	07/19/04			10042773		
				chr	M. STRAWSER	07/19/04			sheet 2		
				appd	M. STRAWSER	07/19/04			sheet 2		
sheet index	revision sheet								cage code	22526	