

4

3

2

1

THIS DRAWING IS UNPUBLISHED. RELEASED FOR PUBLICATION ,19 .

© COPYRIGHT 19 BY AMP INCORPORATED. ALL RIGHTS RESERVED.

LOC	DIST	REVISIONS					
		P	LTR	DESCRIPTION	DATE	DWN	APVD
G	86		G	REVISED PER 0L20-0217-97	04NOV97	DKS	MJS

- ① TIN PL 0.00254 [.000100] MIN THK PER ASTM B-545
- ② NICKEL PL 0.00508 [.000200] MIN THK PER QQ-N-290

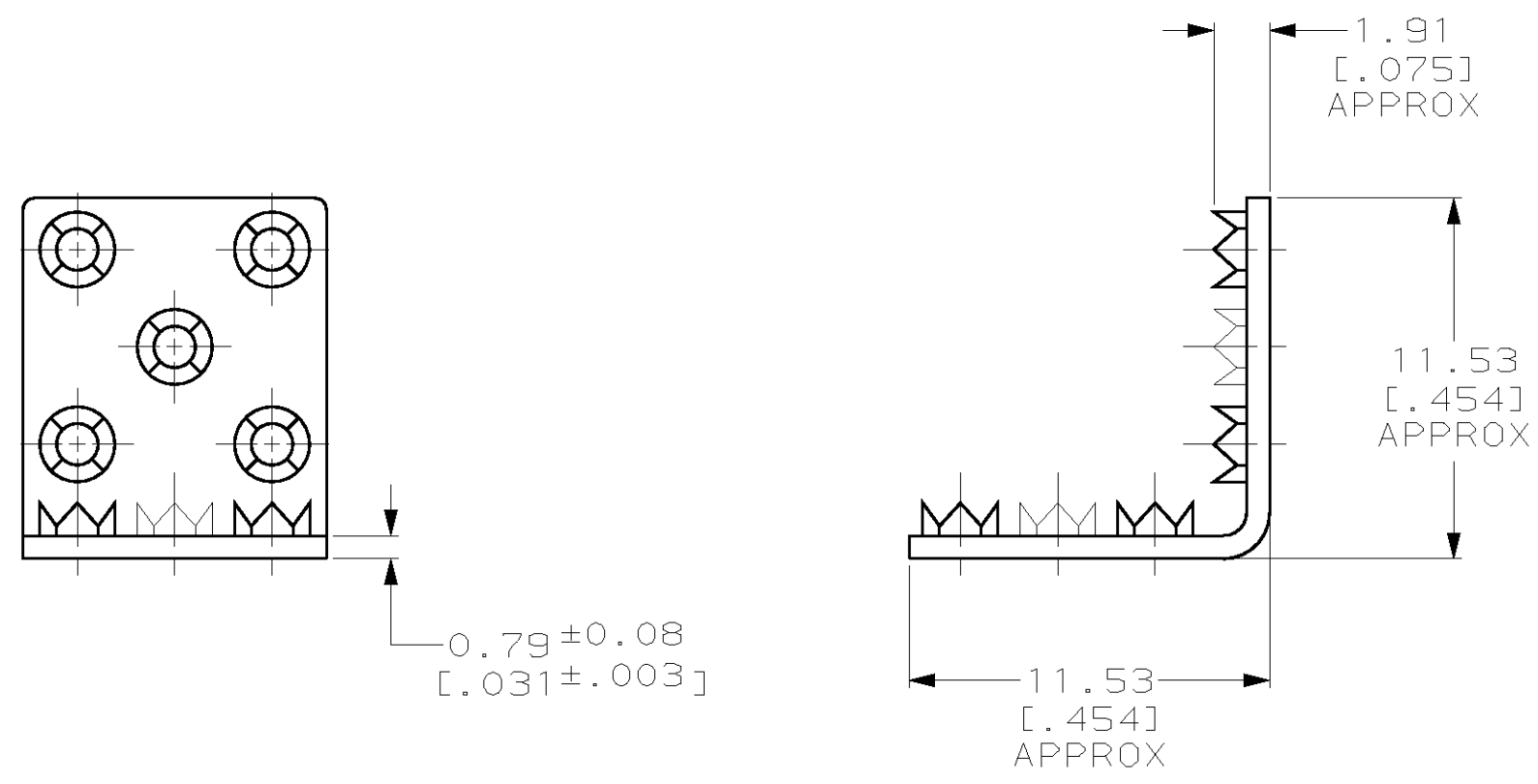

FINISH	OPERATING TEMPERATURE	AMP PART NUMBER
②	343°C MAX	1-329656-1
①	150°C MAX	329656

OBSOLETE

AMP INCORPORATED CUSTOMER SERVICE SYSTEMS

FOR ADDITIONAL PRODUCT INFORMATION OR COPIES OF DRAWINGS AND TECHNICAL DOCUMENTS	PRODUCT INFORMATION CENTER 1-800-522-6752	RECOMMENDED OPERATING TEMPERATURE: SEE TABLE
FOR APPLICATION TOOLING INFORMATION	TOOLING ASSISTANCE CENTER 1-800-722-1111	VOLTAGE RATING: NOT APPLICABLE
FOR ORDER ENTRY	1-800-526-5142	ALUMINUM FOIL THICKNESS: 0.76 [.030] MAX

THIS DRAWING IS A CONTROLLED DOCUMENT.

DIMENSIONS: mm [INCHES]	TOLERANCES UNLESS OTHERWISE SPECIFIED:
	0 PLC ±-
	1 PLC ±-
	2 PLC ±0.20 [.008]
	3 PLC ±-
	4 PLC ±-
	ANGLES ±-
MATERIAL COPPER PER ASTM B-152 ANNEALED	FINISH SEE TABLE

DWN DK SCHRUM	04NOV97
CHK MJ SPICER	03DEC97
APVD JL MECKLEY	03DEC97
PRODUCT SPEC	-
APPLICATION SPEC	-
WEIGHT	-
CUSTOMER DRAWING	

AMP AMP Incorporated
Harrisburg, PA 17105-3608

NAME
**SPLICE, TERMI-FOIL™,
WIRE SIZE: 12-10 AWG**

SIZE	CAGE CODE	DRAWING NO	RESTRICTED TO
A3	00779	C- 329656	-

SCALE 4:1 SHEET 1 OF 1 REV G